

## Drawing Not to Scale

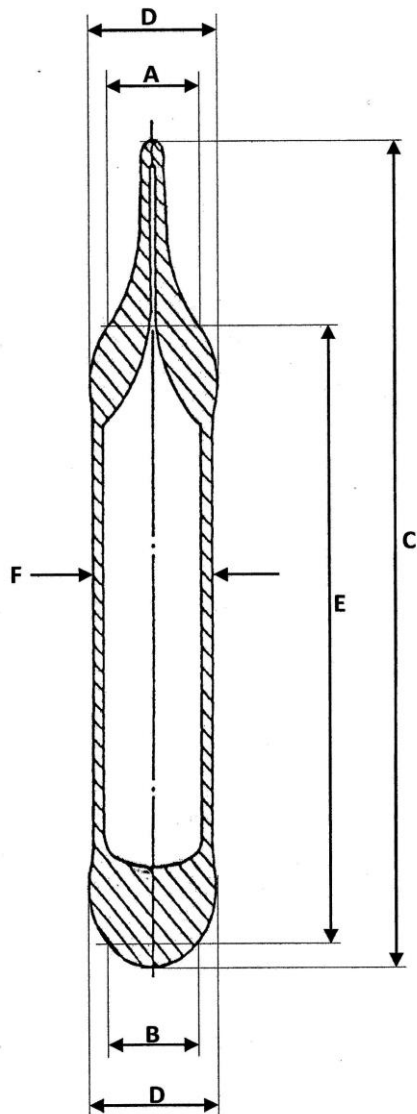

### Technical Data

- 1) The 984 frangible Sprinkler bulb is a 4mm diameter glass bulb, especially designed to meet the requirements for Special Reponse standard Sprinkler heads. It is manufactured from a stock 4mm tube of manufacturer's tolerance.
- 2) During operation the liquid within the bulb will expand until the required operational temperature is reached. At this point the glass bulb will 'burst' and fracture into small fragments, allowing the sprinkler mechanism to operate.
- 3) This bulb is designed to fulfil the requirements of the standards detailed in the table below.
- 4) Precise calibration of the bulbs during the production process enables accurate operating temperatures to be achieved.
- 5) With the 20mm length of the parallel side, the surface area of the glass is maximised to allow the optimum conductivity of heat from the surrounding air to the bulb liquid. This combined with the special formulation of thermally expansive chemicals enables significant improvement in response times

#### Specification

Critical Dimensions (mm)	A = Typical Seat Diameter	B = Typical Base Diameter	C = Max Length	D = Max Strengthening	E = seating Length	F = Body Diameter
	2.7 to 3.2	2.5 min	23.5	4.3	20 Ref only	4 Nominal
Compressive Strength/ Crush Load (kN)	Minimum			LTL Typical		
	3.2			2.5		
Specific end user 'head loads' and the relevant Standard 'Load safety factors' should be taken into consideration.						
Nominal Temperature Range (°C)	Orange	Red	Yellow	Green	Blue	Mauve
	57	68	79	93	141	182
Response Data (Rti)	Typical Operating Time (UL199)			Typical Rti (EN12259)		
	N/A			52		
Standards Applicable	BS EN 12259					



Day-Impex Ltd, Station Road, Earls Colne, Colchester, Essex. CO6 2ER. United Kingdom

Tel : +44(0) 1787 223232  
 Fax : +44(0) 01787 224171  
[www.day-impex.co.uk](http://www.day-impex.co.uk)

Assessed to ISO 9001 Cert No. 291  
 LPCB Ref. No. 291

Title	Bulb Technical Criteria	No	DI-984-01
Changes/Issue History	Rev	Date	<b>Bulb Art No</b>  <b>984</b>
Rti & Operating Time update	C	16/10/08	
Clarification & update of parameters and data	D	11/11/08	
Updating of LPCB mark	E	20/10/15	
Updating of LPCB mark	F	17/10/16	
Authorised	Date	17/10/2016	